

UNLESS OTHERWISE NOTED  
 DIMENSIONS ARE IN INCHES  
 TOLERANCES ARE:  
 ONE PLACE DECIMALS: ± .1 [3] THREE PLACE DECIMALS: ± .005 [.13]  
 TWO PLACE DECIMALS: ± .01 [.3] FOUR PLACE DECIMALS: ± .0020 [.051]

TITLE: ASSEMBLY BOARD TO BOARD SPACING  
 DWG NO: BXX-1XX-X-X-X  
 SHEET 1 OF 1

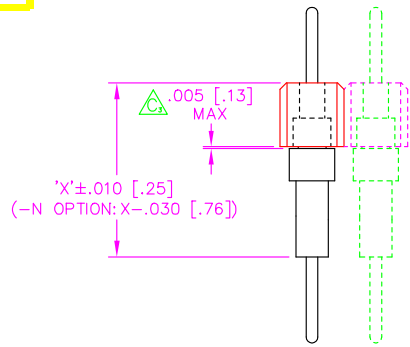

FIG. 1  
(SEE NOTE 4)

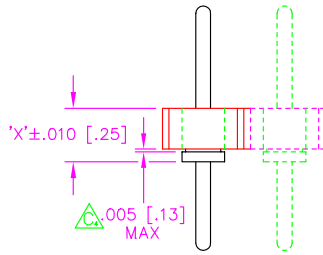

FIG. 2

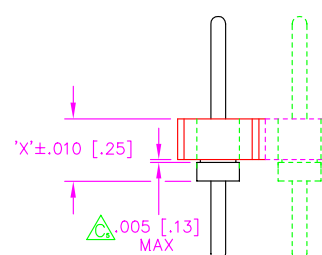

FIG. 3

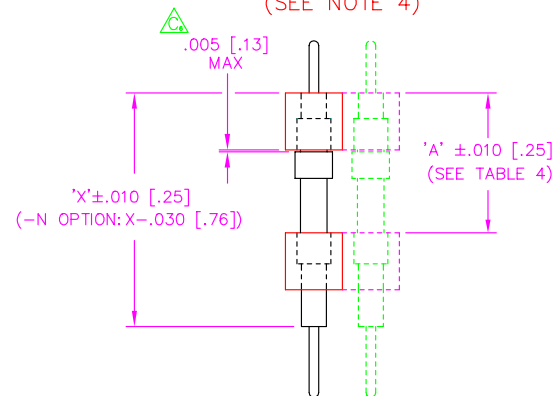

FIG. 4  
(SEE NOTE 4)

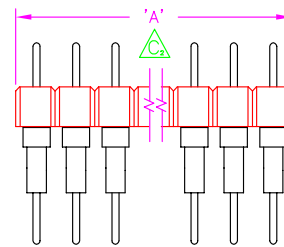
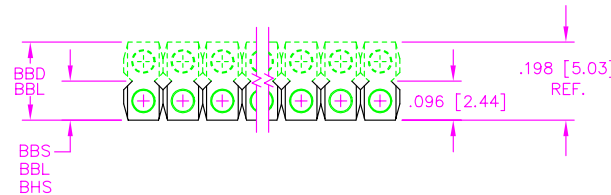

TABLE 4

TERMINAL SPEC.	'A'
-G	.320 [8.13]
-H	.440 [11.18]
-G-N	.290 [7.37]
-H-N	.410 [10.41]

BXX-1XX-X-X-X

OPTION  
 -N: NON-FLUSH-LEAVE BLANK FOR STANDARD (USE BODY SPECIFIED IN TABLE 1) (SEE TABLE 4)

TERMINAL SPECIFICATION (SEE TABLE 2)

PLATING SPECIFICATION (SEE TABLE 2)

-G: SPECIFY -G IN TERMINAL SUFFIX -X  
 -T: SPECIFY -T IN TERMINAL SUFFIX -X  
 -F: SPECIFY -F IN TERMINAL SUFFIX -X

BODY SPECIFICATION (SEE TABLE 1)

BODY STYLE  
 BBS: SINGLE  
 BBD: DOUBLE  
 BDL: SINGLE, LOW PROFILE  
 BBL: DOUBLE, LOW PROFILE  
 BHS: SINGLE, HI-TEMP

BODY LENGTH SPECIFICATION  
 'A': (No. OF POSITIONS X .100±.015)  
 'A': BBS: XX-MAX 32 POSITION  
 'A': BBL: XX-MAX 32 POSITION  
 'A': BHS: XX-MAX 36 POSITION (MUST BE CUT ON MULTI-CUTTER)  
 'A': BBD: XX-MAX 36 POSITION  
 'A': BDL: XX-MAX 36 POSITION

- NOTES:
- MIN. PUSHOUT FORCE: 5 lbs FOR ALL EXCEPT BBL, FOR BBL: 2 lbs. MIN.
  - MAX ALLOWABLE BOW: FOR STRIPS MOLDED IN VALOX=.009 IN/IN FOR STRIPS MOLDED IN ULTEM=.003 IN/IN (FOR BHS ONLY: .004 IN/IN TOP TO BOTTOM, .008 IN/IN SIDE TO SIDE.) (FOR BBL ONLY: .055 MAX.)
  - △ REPRESENTS A CRITICAL DIMENSION.
  - ON BBD STYLE (OR BODIES), COUNTERBORE IN DSB BODY SHOULD BE REVERSED FROM VIEW SHOWN.

TABLE 1

BODY SPECIFICATION

BODY STYLE	BODY	
	STANDARD	-N OPTION
BBS-	TBS-32	SSB-XX
BBD-	DSB-36	DSB-XX
BBL-	SSL-XX	N/A
BDL-	SDL-XX	N/A
BHS-G (PLATING)	HTS-36-G	SSB-XX-U

ASSEMBLY INSTRUCTIONS

PACKAGING

TABLE 3

BODY	LEAD STYLE	PACKAGING TUBE	PLUG
BHS	A	PT-1-24-01-24	TP-24
	B	PT-1-24-02-03	TP-24
	D,H	PT-1-24-02-04	TP-07
	G	PT-1-24-10-03	TP-03
BBS	A	PT-1-24-01-24	TP-24
	B	PT-1-24-02-03	TP-24
	D,H	PT-1-24-02-04	TP-07
	C,G	PT-1-24-10-03	TP-03
BBD	A	PT-1-24-01-22	TP-03
	B	PT-1-24-06-03	TP-07
	C,D,G,H	PT-1-24-08-03	TP-07
BBL	ALL	PT-1-24-01-23	TP-12
BDL	ALL	PT-1-24-01-14	TP-03

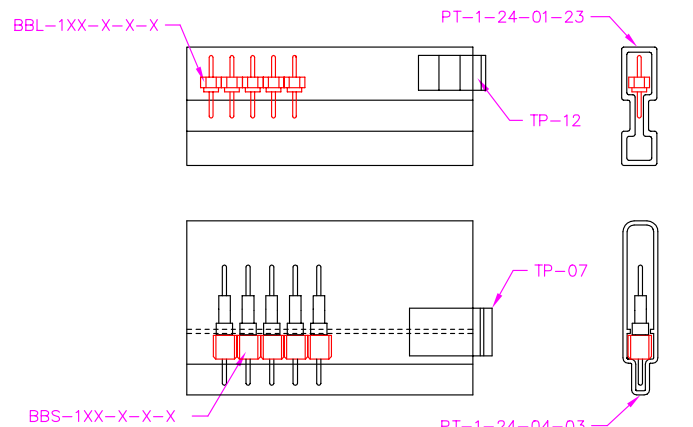

TABLE 2

TERMINAL SPECIFICATIONS

LEAD STYLE	BODY SPEC.			BODY SPEC.		
	BBS,BBD,BHS	'X'	FIG.	BBL,BDL	'X'	FIG.
A	T-1R14-1-X	.210 [5.35]	1	N/A		
B	T-1R14-2-X	.335 [8.51]		N/A		
C	T-1R14-3-X	.585 [14.86]		N/A		
D	T-1R14-4-X	.835 [21.21]		N/A		
E	N/A		4	T-1R6-X	.070	2
F	N/A			T-2R6-X	.085	3
G	T-1R14-5-X	.585 [14.86]		N/A		
H	T-1R14-6-X	.835 [21.21]	N/A			

PROPRIETARY NOTE  
 THIS DOCUMENT CONTAINS INFORMATION CONFIDENTIAL AND PROPRIETARY TO SAMTEC INC. AND SHALL NOT BE REPRODUCED OR TRANSFERRED TO OTHER DOCUMENTS OR DISCLOSED TO OTHERS OR USED FOR ANY PURPOSE OTHER THAN THAT FOR WHICH IT WAS OBTAINED WITHOUT THE EXPRESSED WRITTEN CONSENT OF SAMTEC INC.

PLOT SCALE = NTS



520 PARK EAST BLVD. NEW ALBANY, INDIANA 47150  
 PHONE (812) 944-6733 P.O. BOX 1147  
 CODE 55322

MADE BY: TY 2-18-85  
 CHECKED BY: L. WILLIAMS 2-23-85  
 ENGINEER APPROVAL: BXX-1XX-X-X-X  
 SHEET 1 OF 1