

UNLESS OTHERWISE NOTED DIMENSIONS ARE IN INCHES TOLERANCES ARE

ONE PLACE DECIMAL : .1	THREE PLACE DECIMAL : .010	ANGLES ±
TWO PLACE DECIMAL : .01	FOUR PLACE DECIMAL : .0020	

TITLE:
 .100 BOTTOM MOUNT SOCKET ASSEMBLY

DWG NO.
 BSW-1XX-XX-X-X-X
 SHEET 1 OF 1

ASSEMBLY INSTRUCTIONS

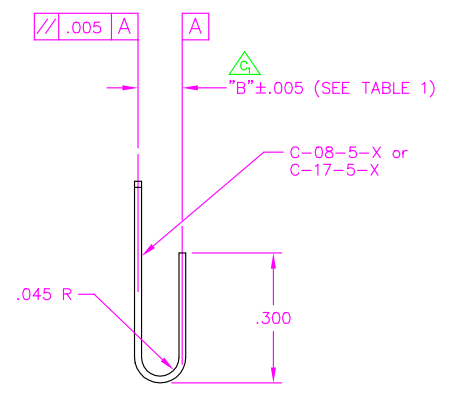
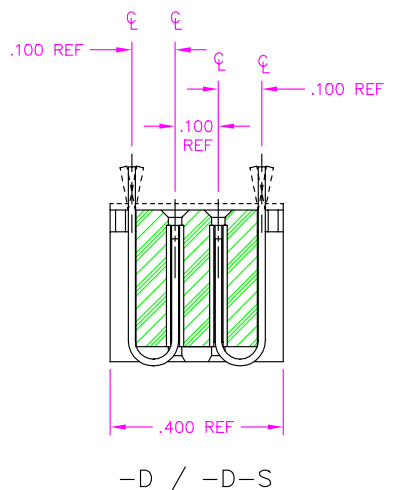
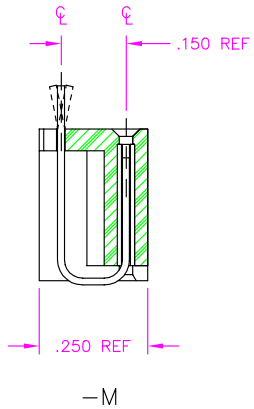
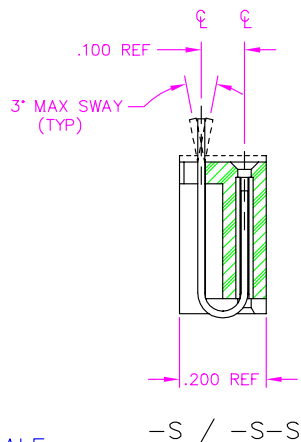
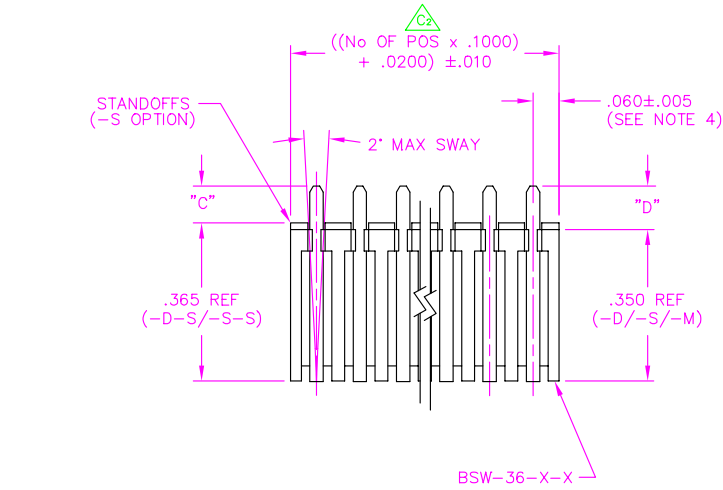

BSW-1XX-XX-X-X-X

No OF POSITIONS
 -02 THRU -36

STYLE
 -04: C-8-5-X (STANDARD I/W FORCES)
 -24: C-17-5-X (LOW I/W FORCES)

OPTION
 -S: STANDOFFS (USE BSW-36-X-S, SEE TABLE 1)

ROW OPTION
 SEE TABLE 1

TABLE 1

ROW	"B"	"c"	"d"	USE BODY
-D	.100	-	.170	BSW-36-D
-S	.100	-	.170	BSW-36-S
-M	.150	-	.135	BSW-36-M
-D-S	.100	.155	-	BSW-36-D-S
-S-S	.100	.155	-	BSW-36-S-S

PLATING SPECIFICATION

- G: GOLD (USE C-XX-5-G)
- T: TIN (USE C-08-5-T, STYLE -04 ONLY)
- S: SELECTIVE GOLD (USE C-XX-5-S)
- H: HEAVY GOLD (USE C-08-5-H, STYLE -04 ONLY)

FINAL ASSEMBLY

DO NOT SCALE FROM THIS PRINT

POSITION NUMBER LAYOUT

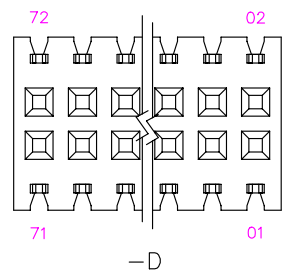
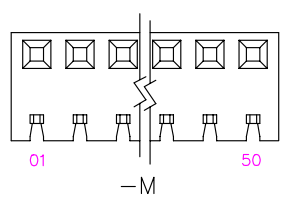
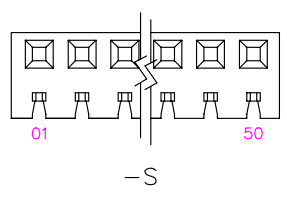

- NOTES
1. MAXIMUM ALLOWABLE BOW: .003 INCH/INCH AFTER ASSEMBLY.
 2. CONTACT PUSHOUT FORCE: 3 lbs. MINIMUM.
 3. △ REPRESENTS A CRITICAL DIMENSION.
 4. "END WALLS" AFTER CUTTING SHOULD BE .023±.005.

PROPRIETARY NOTE
 THIS DOCUMENT CONTAINS INFORMATION CONFIDENTIAL AND PROPRIETARY TO SAMTEC, INC. AND SHALL NOT BE REPRODUCED OR TRANSMITTED IN ANY FORM OR BY ANY MEANS, ELECTRONIC OR MECHANICAL, INCLUDING PHOTOCOPYING, RECORDING, OR BY ANY INFORMATION STORAGE AND RETRIEVAL SYSTEM, WITHOUT THE EXPRESS WRITTEN CONSENT OF SAMTEC, INC.



810 PROGRESS BLVD. NEW ALBANY, INDIANA 47150
 PHONE (812) 944-6733 P.O. BOX 1147
 CODE 55322

MADE BY: PURVIS 3-31-98

BSW-1XX-XX-X-X-X
 SHEET 1 OF 1